

NON-CONTROLLED COPY
 INFORMATION SUBJECT TO CHANGE WITHOUT NOTICE
 VERIFY REV LEVEL OF PAPER COPY WITH REV LEVEL ON PPC WEB SITE

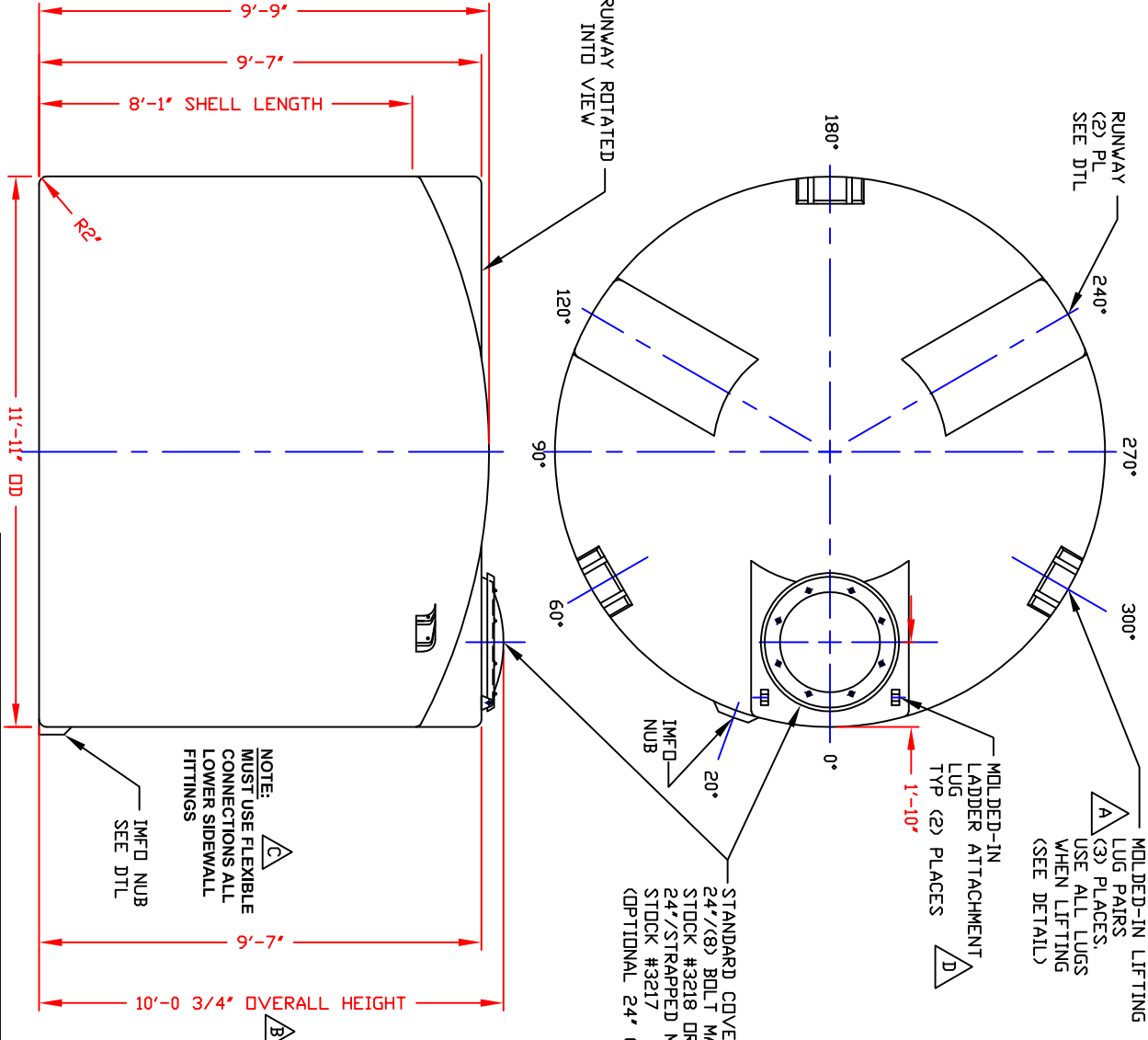

SERVICE	MK STOCK	NOZLE SCHEDULE & ACCESSORIES	NOZ SIZE	DEG ELEV

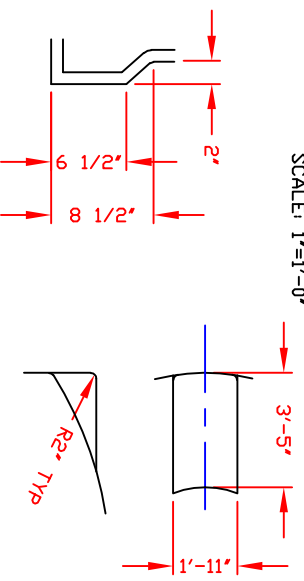
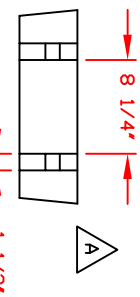

NOTES:
 1. THIS IS A COMPUTER GENERATED DWG. DO NOT REVISE BY HAND.
 2. DIMENSIONS WILL VARY ±3% DUE TO VARIATIONS IN MULTIPLE MOLDS & CONDITIONS PREVALENT DURING MANUFACTURE & USAGE.
 3. NO MOLDED IN GALLONAGE MARKERS THIS TANK.

CALCULATED CAPACITIES/ VOL VOLUME IN U.S. GALLONS	DESIGN CAP	DOME VOL	TOTAL VOL
6639	675	7314	

CONFIDENTIAL PROPERTY OF
 POLY PROCESSING COMPANY
 NOT FOR REPRINT OR USE
 WITHOUT PERMISSION

REV 'D'	ADDED LADDER ATTACHMENT LUGS BY:JB 5/14/04 CK:WM
REV 'C'	ADDED FITTING NOTE BY:MBW 2/17/03 CK:JB
REV 'B'	ADDED DIMENSION BY:JB 10/21/02 CK:MBW
REV 'A'	ADDED LIFTING LUGS & DETAIL BY:JB 9/3/02 CK:WM

DWG TITLE
 6550 GALLON UPRIGHT TANK

SCALE: 3/8"=1'-0"

DATE: 10/10/19

DR: B. HARPER

SHEET: 1 OF 1
VERT: 06650
REV: D

POLY PROCESSING SOLUTIONS, SIMPLIFIED
 Central Region
 3601 Hwy 48th Street
 Dallas, TX 75246
 Phone: 972-382-2600
 Fax: 972-382-9999