

NON-CONTROLLED COPY
 INFORMATION SUBJECT TO CHANGE WITHOUT NOTICE
 VERIFY REV LEVEL OF PAPER COPY WITH REV LEVEL ON PPC WEB SITE

MOLDED-IN LIFTING LUG PAIRS
 (4) PLACES
 USE MINIMUM OF (1) LUG AT EACH LOCATION FOR LIFTING (SEE DETAIL)

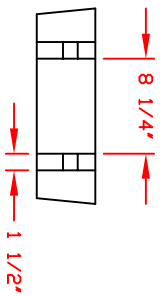

LIFTING LUG DETAIL
 (4) PLACES
 SCALE: 1"=1'-0"

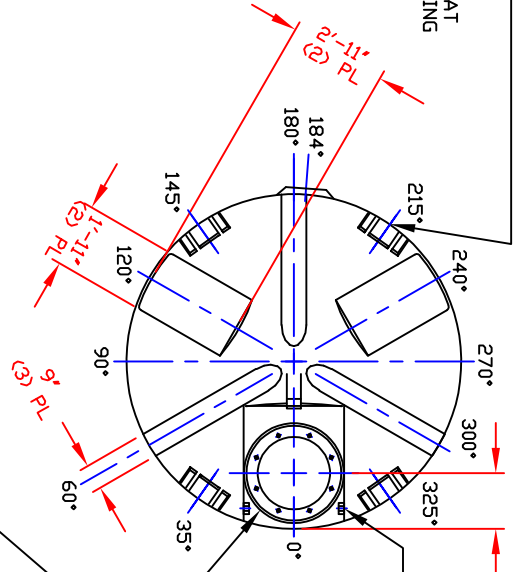

STANDARD COVER:
 24"/(8) BOLT MANWAY COVER/PE (SHOWN)
 PPC STOCK NO. 3218 OR
 24"/STRAPPED MANWAY COVER/PE
 PPC STOCK NO. 3217
 (OPTIONAL 24" COVERS AVAILABLE)

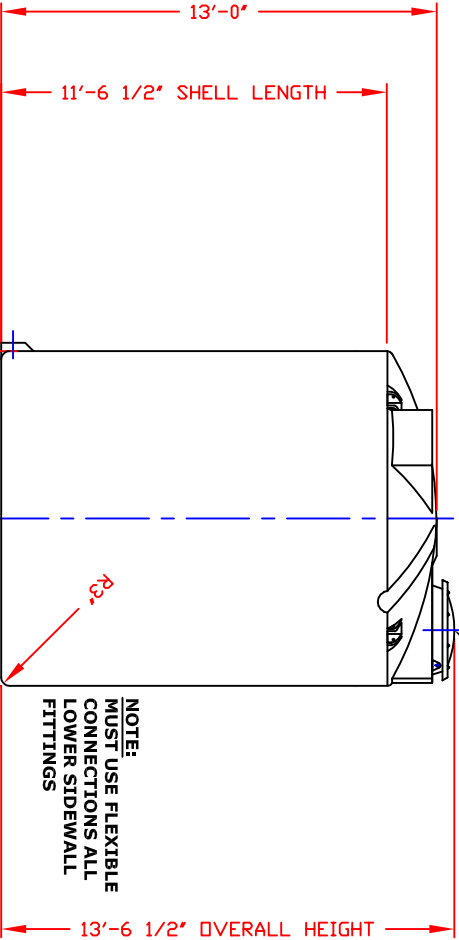

NOTE:
 MUST USE FLEXIBLE CONNECTIONS ALL LOWER SIDEWALL FITTINGS

- NOTES**
1. THIS IS A COMPUTER GENERATED DWG. DO NOT REVISE BY HAND.
 2. DIMENSIONS WILL VARY ±3% DUE TO VARIATIONS IN MULTIPLE MOLDS & CONDITIONS PREVALENT DURING MANUFACTURE & USAGE.
 3. NO MOLDED IN GALLONAGE MARKERS THIS TANK.

CALCULATED CAPACITIES/ VOLUME IN U.S. GALLONS	
DESIGN CAP DOME VOL TOTAL VOL	6628 265 6893

CONFIDENTIAL PROPERTY OF
 POLY PROCESSING COMPANY
 NOT FOR REPRINT OR USE
 WITHOUT PERMISSION

DWG TITLE		6600 GALLON UPRIGHT TANK	
SCALE:	1/4"=1'-0"		Western Region 1000 South 4th Street Cedar Rapids, IA 52404 FAX (319) 382-0000
DATE:	10/17/19		
SHEET		DR:	B. HARPER
1 OF 1		CK:	
COMPUTER FILE		REV	-